



MOBILE SHOTBLASTER ELEPHANT OWNER'S MANUAL AND PARTS BOOK



www.BARTELLGLOBAL.com

Doc. # OIPB-C
Orig. Rel. - 11/2018
Curr. Rev. - 00



This Page Left Intentionally Blank



www.BARTELLGLOBAL.com

Bartell Morrison Inc.
170 Traders Blvd E
Mississauga, Ontario, Canada
L4Z 1W7
Tel: (647) 953-4100
Fax: (647) 953-4101

Bartell Morrison USA LLC
200 Commerce Drive, Unit A
Freehold, NJ, USA
07728
Tel: (848) 225-8100
Fax: (848) 225-8101

SPE International Ltd
Honeyholes Lane
Dunholme, Lincoln, England
LN2 3SU
Tel: 01673 860709
Fax: 01673 861119

Innovatech
4701 Allmond Ave
Louisville, Kentucky, USA
40209
Tel: (425) 405-9100
Fax: (425) 405-9101

**ORIGINAL LANGUAGE OPERATING MANUAL FOR
CONTEC SHOT BLASTER**

© 2019 Bartell Morrison Inc.

No part of this work may be reproduced or transmitted in any form or by any means, electronic or mechanical, including photocopying and recording, or by any information storage or retrieval system without the prior written permission of Bartell Morrison Inc. unless such copying is permitted by federal copyright laws.

Address inquiries or reference permissions care of:
Bartell Morrison Inc., 170 Traders Blvd. E, Mississauga, Ontario, Canada, L4Z 1W7

REV.	DATE	DESCRIPTION	APPROVED BY:
00	11/2018	Initial Release	AN





SAFETY PRECAUTIONS	
	<p style="text-align: center;">DANGER EXPLOSION HAZARD</p> <p>Never operate the machine in an explosive atmosphere, near combustible materials, or where ventilation does not clear exhaust fumes.</p>
	<p style="text-align: center;">WARNING BURN HAZARD</p> <p>Never come into contact with the engine or muffler when engine is operating or shortly after it is turned off. Serious burns may occur.</p>
	<p style="text-align: center;">CAUTION ROTATING HAZARD</p> <p>Never place hands or feet inside safety guards. Serious injury will result from contact with rotating parts.</p>
	<p style="text-align: center;">CAUTION MOVING PARTS</p> <p>Before starting the machine, ensure that all guards and safety devices are in place and functioning properly.</p>
	<p style="text-align: center;">ATTENTION READ OWNER'S MANUAL</p> <p>Read and understand owner's manual before using this machine. Failure to follow operating instructions could result in serious injury or death.</p>

TABLE OF CONTENTS

<u>QUALITY ASSURANCE/ MACHINE BREAK IN</u>	5
<u>WARRANTY INFORMATION</u>	5
<u>SPECIFICATIONS</u>	6
<u>PREVENTATIVE MAINTENANCE AND ROUTINE SERVICE PLAN</u>	7
○ ROUTINE SERVICE SCHEDULE	8
○ ROUTINE SERVICE INTERVALS	8
<u>OPERATING SAFETY PRECAUTIONS</u>	9
<u>OPERATION INSTRUCTIONS</u>	10
○ SETTING UP YOUR SHOT BLASTER	10
○ OPERATION	10
○ ADJUSTING THE BLAST TRACK	11
○ BLAST WHEEL AND SHOT CAGE INSPECTION	11
<u>PARTS LIST - ELEPHANT SHOT BLASTER</u>	13
○ ELEPHANT SHOT BLASTER - PARTS LIST	14
<u>ELECTRICAL DIAGRAM - ELEPHANT SHOT BLASTER</u>	16
○ TROUBLE SHOOTING	17
<u>DECLARATION OF CONFORMITY</u>	18

QUALITY ASSURANCE/ MACHINE BREAK IN

The Contec Shot Blaster is the product of extensive engineering development designed to give long life and unmatched performance. The Shot Blaster are shipped completely assembled.

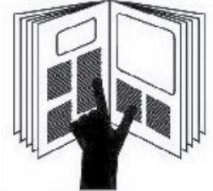
You can help ensure that your Shot Blaster will perform at top levels by observing a simple routing on first use. Consider that your new Shot Blaster is like a new car. Just as you would break in a new car to the road or any new machine to the job, you should start gradually and build up to full use. Learn what your machine can do and how it will respond. Full throttle and control may be used after this time period, as allowed by material. This will serve to further break in the machine on your specific application, as well as provide you with additional practice using the machine.

We thank you for the confidence you have placed in us by purchasing a Shot Blaster and wish you many years of satisfied use.

WARRANTY INFORMATION

Bartell agrees to furnish without charge, F.O.B. our plant, a replacement for any part or portion thereof, comprising the main unit of the Contec Shot Blaster, consisting of the handle, housing assembly, save and except tooling, and power units, prove upon our examination, to be defective in either material or workmanship within a period of twelve (12) months from date of purchase, provided that notice of such defective part or portion thereof is given to Bartell Ltd. within the twelve month warranty period. No further or other guarantee or warranty expressed or implied in connection with the sale of the Shot Blaster is given and our sole liability consists in replacing defective parts or portions thereof. We shall not be responsible for any special, indirect or consequential damages arising in any manner whatsoever.

This guarantee is for the sole benefit of the original purchaser as end user. Our responsibility under this guarantee ends in the case the original purchaser transfers ownership of the Shot Blaster, makes any changes or adds any parts or devices not of our manufacture to the Shot Blaster machine.

SPECIFICATIONS

ELEPHANT	
Dimensions	
Working Width, mm (in)	200 (8)
Overall Width, mm (in)	40 (16)
Overall Length, mm (in)	70-115 (28-45)
Overall Height, mm (in)	64-90 (25-35)
Weight	
Weight, kg (lb)	120 (264)
Power Source	
Power kw (HP)	3.6 (5)
Volts (V)	230
Frequency (Hz)	60
Amperage (A)	22

ROUTINE SERVICE SCHEDULE

Routine Service Intervals		Each Use	After 1.5 months or 50 hrs	Each 3 months or 100 hrs	Each 6 months or 200 hrs	Each 9 months or 300 hrs	Each 12 months or 400 hrs
General Inspection							
Guards	Check		○	○	○	○	○
Warning Stickers	Check		○	○	○	○	○
Test Run	Check Operation		○	○	○	○	○
Fasteners	Check Tightness	○					
Electrical							
Cord	Check for Damage	○					
Plug	Check for Damage	○					
Switches/Buttons	Check	○					
Blasting Components							
Blast Wheel	Check		○	○	○	○	○
Shot Cage	Check			○		○	
Blast Chamber	Check			○		○	
Reclaim Chamber	Check			○		○	
All Sealing around Blast Opening	Check	○					
Magnetic Frame				○		○	
Motor							
Fan	Check - Clean		○	○	○	○	○

ROUTINE SERVICE INTERVALS

Due to the nature and environment of use, Shot Blasters could be exposed to severe operating conditions. Some general maintenance guidelines will extend the useful life of your machine.

- The initial service for your Shot Blaster should be performed after 25 hours of use, at which time your mechanic (or authorized repair shop) should complete all the recommended checks in the schedule above. The maintenance log is handy for keeping a record of the maintenance performed and the parts used for servicing your Shot Blaster.
- Regular service according to the schedule above will prolong the life of the Shot Blaster and prevent expensive repairs.
- Keeping your Shot Blaster clean and free from debris is the single most important regular maintenance operation, over and above the checks in the service schedule above, that can be performed. After each use your Shot Blaster should be cleaned to remove any dust and debris from the undercarriage and surrounding components.
- In the Service Schedule above, items that should be checked, replaced or adjusted are indicated by “o” in the appropriate column. For ease of recording place, a checkmark through the “o” when the item is complete. If an item is not required or not completed place an “x” through the “o” in the box.
- Failure to have your Shot Blaster regularly serviced and properly maintained in accordance with the manufacturer’s instructions will lead to premature failure and void the warranty.

OPERATING SAFETY PRECAUTIONS

The ELEPHANT Shot Blasters are constructed according to existing safety rules and regulations. These technical precautions should not be removed or changed under any circumstances. While operating the machines the following points should also be kept in mind:

IMPORTANT: NEVER attempt to disable or circumvent these safety devices. They are present for the operator's protection and any tampering will result in substantial risk to the operator and all present at the job site. If your compactor's safety devices have been tampered with, do not use the equipment. Immediately contact your sales representative to obtain replacement parts or return the compactor to your dealer for repairs.

The instructions provided in this manual are done so to ensure the operator's safety as well as that of others, the equipment, and the job site. Failure to follow these guidelines can lead to serious personal injury and even death. The operator and any service personnel should read and understand the entire manual before working with or servicing any Contec Shot Blaster.

- Disconnect the machine before commencing any servicing or maintenance work
- In nearly every part of the ELEPHANT® high electrical currents and mechanical forces are transmitted. The danger of injury is therefore not only from electric shock, but also from moving parts of the machine.
- It is necessary to use safety goggles with side protectors and ear plugs. All persons, in the operating area of the Shot blaster must take these precautions. When switching on, or lifting the machine during blasting, it is possible that shot escapes at high speed. Unprotected eyes can be seriously damaged.
- Never wear loose or poorly fitting clothing. Flapping sleeves may be pulled into the machine causing serious injury.
- All rotating parts of the machine are suitably protected by covers, which prevent clothes or similar from entering the machine. Under no circumstances should these covers be removed before you switch the machine on.
- Access by unauthorised persons into the blasting area should be prevented. (Due to a high risk of slipping on lost shot)
- The ELEPHANT® should be switched off immediately if unusual noises or vibrations are detected during the operating of the machinery. A thorough check must be carried out in order to detect the cause.
- Always pre-check the floor for undulations, steps, stones, screws or other foreign bodies. It might be necessary to brush, or in extreme cases, vacuum the floor. Wet or oily spots can make blasting impossible and damage the Dust Collector.
- Check the power cables regularly as damage may have occurred while operating the machine or transportation. Always disconnect the cables before examination and treat all electrical parts with extreme care.

OPERATION INSTRUCTIONS

SETTING UP YOUR SHOT BLASTER

Your Elephant Shot Blaster comes fully assembled with handle and motor fully installed. Transport the ELEPHANT® and the Dust Collector to the floor which is to be blasted. Shot can now be loaded, and your Shot Blaster is ready for use.

OPERATION

Operating

Check and make sure that all wear & tear parts are in good condition. If there are any doubts, replace them immediately. Check the power cables.

Connect the ELEPHANT® with the hose to the Dust Collector. It is important, that there are no lesions or holes in the whole length of the hose. Even small holes or a wrong connection can significantly decrease the performance of the dust collector.

Connect the power cables of the ELEPHANT® and the Dust Collector to the sockets. Insulation tape or similar can be used to secure the power cable to the hose.

Check the floor for screws, nuts or stones etc., and sweep the floor if necessary, with a brush or a vacuum system. Small obstacles like joints pose no problems for the ELEPHANT®. If there are bigger steps or similar check if it is possible for the machine to drive over them before the turbine is switched on.

In the case of higher steps, difficult joints or severe undulation of the floor it is possible, that the blast opening of the machine rises too far above the floor. The sealing of the Shot blaster becomes ineffective and shot escapes from the machine at high speed. This can cause injury to persons and equipment. Before operating always check the condition of the floor to prevent this from occurring.

Remove the separator lid. Make sure that the shot valve is closed and pour in the shot until it reaches the level of the sieve. Do not fill above the sieve level as suction from the Dust Collector will suck it away with the dust. Only place new or clean shot in the shot compartment.

Clean the sieve in the shot compartment if it is blocked.

Switch the Dust Collector on.

Switch the turbine on.

Push the shot valve lever on the right side of the handle. The ELEPHANT® will start to blast the floor. Pull or push the machine in the direction you want. If the machine stays still on one spot, it will blast a hole in the floor!

After a few meters of blasting close the shot valve and stop the machine. Check the track on the floor. If the track is not evenly blasted, adjust the position of the shot cage as described in the “Adjusting the Blast Track” Section.

The dust container of the Dust Collector must be emptied on a regular basis. The intervals depend on the size of the container and on the condition of the floor.

ADJUSTING THE BLAST TRACK

The blasting path is adjusted by turning the shot cage in the blast chamber. If blasting leaves an uneven path, then one side of the path is being blasted more heavily than the other. Remove the shot hose situated in between shot valve and shot enter pipe. The shot cage is situated under the shot enter pipe. It is secured by two screws situated on both sides of the shot enter pipe. Loosen the screws, remove the shot enter pipe and the shot cage will turn freely.

If the path is heavier on the left-hand side compared to the right, turn the cage counter-clockwise. Turn in a clockwise direction if the path is heavier on the right-hand side. Retighten the screws, fix the shot enter pipe and shot hose and try a test run. Repeat the adjustment if necessary, until the path is smooth, even and without variation.

BLAST WHEEL AND SHOT CAGE INSPECTION

The blast wheel is a pure wear & tear part and must be checked regularly. It is recommended to do a first check after approximately 50 hours of blasting. The life time of the blast wheel depends on the application of the machine.

For example, a lot of wear & tear occurs when blasting soft concrete with a lot of surface fat. Concrete dust is a very aggressive substance and increases wear & tear enormously. This decreases when blasting steel or ceramic tiles. To give an accurate figure for the lifetime of the wheel is therefore impossible. As a rough guide, this could be anywhere between 50 and 150 hours.

Take off the blast chamber with the reclaim chamber. The reclaim chamber is fixed with 4 screws on the blast chamber. The flange of the reclaim chamber must be sealed with silicon. The blast chamber is also fixed with 4 screws to the machine frame. It should also be sealed with silicon.

Now the blast wheel should be visible. In the middle of the wheel there is a hexagonal shaped screw. Loosen the screw and remove the wheel from the blast chamber. Check the wear & tear on the wheel. The thickness of the five blades should not be less than 3 mm. If less, the blade could break and destroy the whole wheel. The same applies, if one of the blades is damaged or broken as a result of a foreign body entering the wheel.

The shot cage is like the blast wheel - a pure wear & tear part and must be checked regularly. Two different kinds of wear & tear on the cage are possible. The window in the cage has a width of 30 mm. Change the cage if this width is more than 33 mm. The second type of wear & tear is the decrease in the thickness of the cage wall itself. Change the cage before a hole appears.

If the blast wheel and cage are in a good condition replace the parts using the opposite direction to that described above.



This Page Left Intentionally Blank

PARTS LIST - ELEPHANT SHOT BLASTER

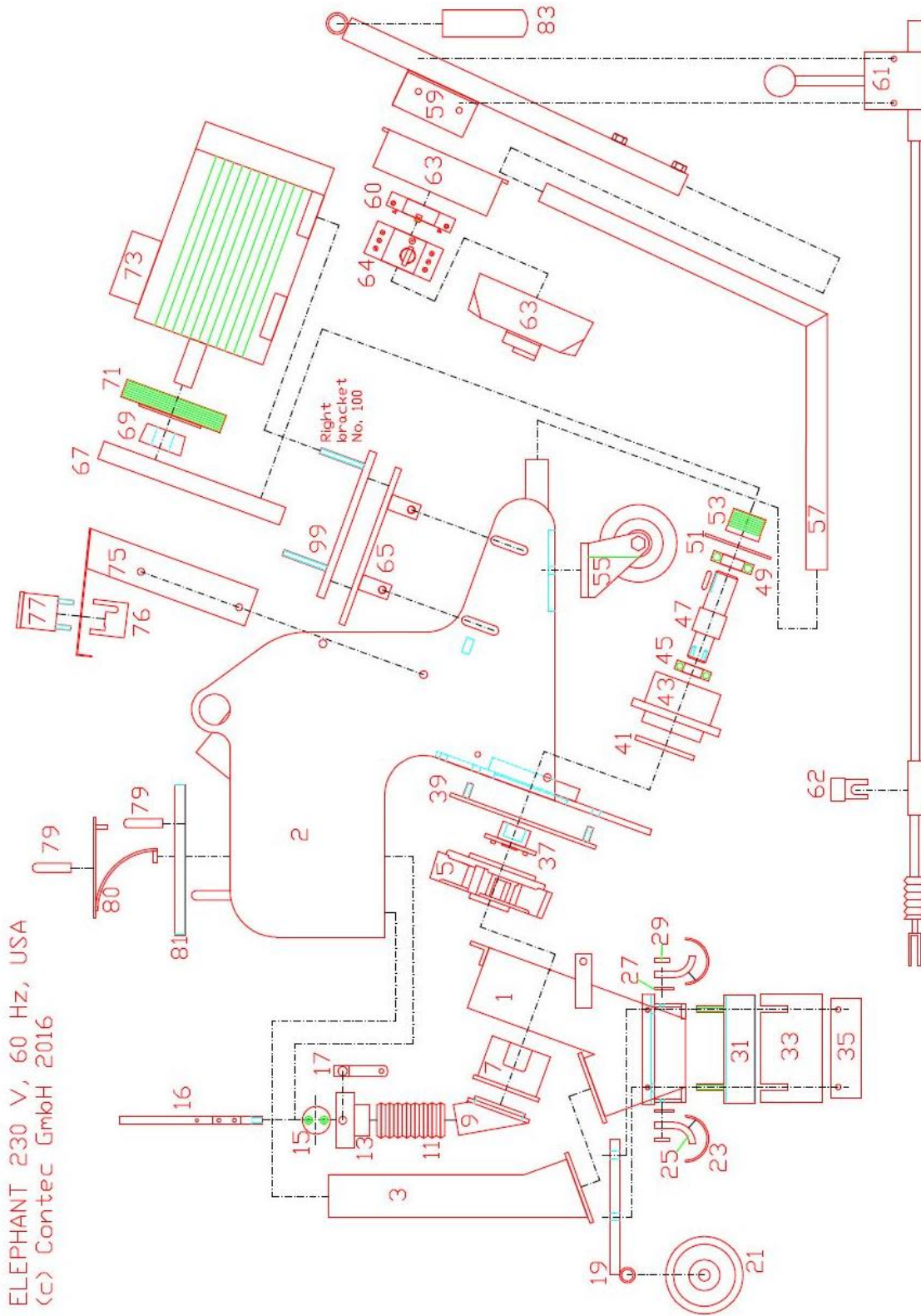

ELEPHANT 230 V, 60 Hz, USA
(c) Contec GmbH 2016

ELEPHANT SHOT BLASTER – PARTS LIST

Item #	Part #	Description	QTY	Remarks
1	8712100100	Blast Chamber	1	
2	8711100000	Machine Frame	1	
3	8712120100	Reclaim Chamber	1	
5	8730151900	Blast Wheel	1	
7	8730151702	Shot Cage	1	
9	8731100300	Shot Enter Pipe	1	
11	8770254001	Shot Hose	1	
13	8731140302	Shot Valve Pipe with Magnets	1	
15	8731100307	Shot Valve Lid	1	
16	8731100306	Shot Valve Axis	1	
17	8731100301	Shot Valve Lever	1	
19	8731201332	Front Wheel Axis	1	
21	8780201040	Front Wheel	1	
23	8731100801	Back or Front Skirt half Pipe	2	
25	8771230801	Back Skirt Rubber front/rear	2	
27	8771230802	Rubber for Skirt front/rear	2	
29	8731100702	Bracket for Skirt front/back	2	
31	8731100600	Magnetic Frame Left/Right	2	
33	8772238006	Rubber Sealing Magnets	2	
35	8731100901	Bracket for Rubber Sealing	2	
37	8731171005	Blast Wheel Socket	1	
39	8712120200	Lining Blast Chamber	1	
41	8731171002	Plate Bearing Housing Wheel	1	
43	8731171001	Bearing Housing	1	
45	8761206305	Bearing	1	
47	8731171004	Turbine Axis	1	
49	8761206306	Bearing	1	
51	8731171003	Plate Bearing Housing Belt Drive	1	
53	8790240044	Pulley	1	
55	8780206260	Rear Caster	1	
57	8731100401	Bracket for Handle	1	
59	8731100500	Handle	1	
60	8751203004US	Low Voltage Protective	1	
61	8790200010	Control Lever	1	
62	8790200001	Bracket for Control Lever	1	
63	8751101000	Switch Box	1	
64	875110025US	Motor Protective	1	
65	8731101200	Motor Plate	1	
67	8770240864US	Poly-V Belt	1	
69	879024161028	Taper Bush	1	
71	8790241125US	Pulley	1	
73	8755030350	Motor	1	



75	8731101000	Belt Drive Cover	1	
76	8751203000	Cover for Amp meter	1	
77	8751203025	Amp meter	1	
79	8790215016	Handle	2	
80	8731100100	Shot Compartment Lit	1	
81	8731100105	Sieve	1	
83	7870-1-6-0	Rubber Grip	2	
99	8731101101	Bracket left	1	
100	8731101102	Bracket right	1	

ELECTRICAL DIAGRAM – ELEPHANT SHOT BLASTER

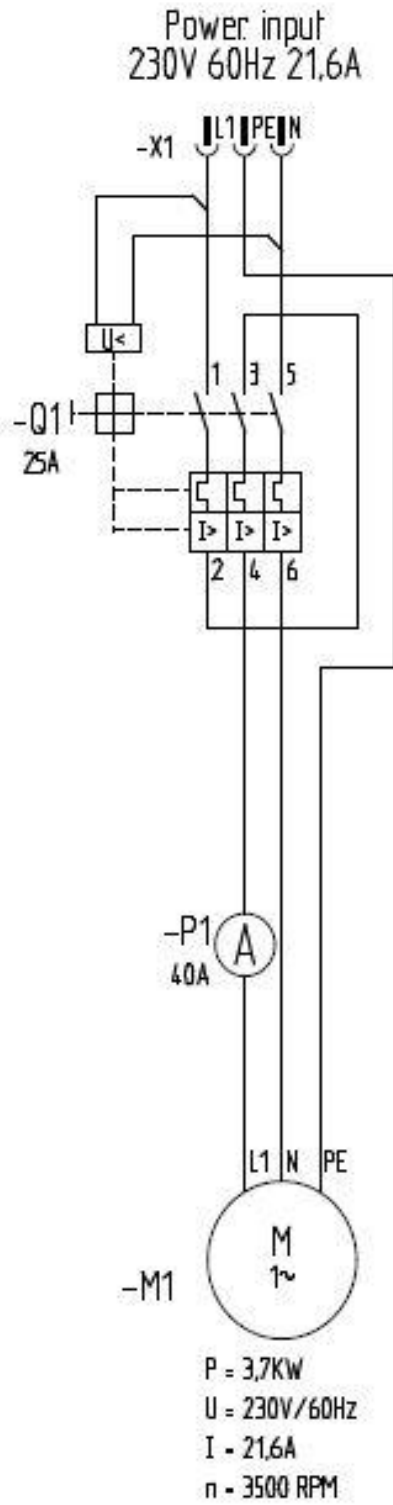

TROUBLE SHOOTING

The turbine motor is not working.

- Has the blast chamber filled with shot and blocked the blast wheel during transportation of the machine?
- Is the power connection correct? (230V, single phase or 400/460V three phase)
- Is the motor overload protection tripped? (The turbine switch is also the overload protection)
- Are the cables in good condition and properly laid?

The blast performance is too low.

- Has the blast wheel worn out?
- Has the shot cage been correctly adjusted?
- Is the shot cage worn out?
- Is the sieve (Appendix diagram No. 81) in the shot compartment blocked?
- Is the shot valve (Appendix diagram No. 13) blocked?
- Has the shot worn out? (Check the size of the shot)

The ELEPHANT® works for a short time and then loses all the shot ('carpeting effect').

- Has the blast wheel worn out?
- Has the shot cage been correctly adjusted?
- Is the shot cage worn out?
- Does the rubber sealing of the magnetic frame lie snugly with the floor?
- Is the rubber sealing worn out?
- Is the belt of the turbine too loose? (The belt will slip on the pulleys and the blast wheel will not rotate quickly enough)
- Is it possible to blast the floor? Check the condition. Is it dry and not too elastic or soft?

DECLARATION OF CONFORMITY

Declaration of Conformity / Certificat de conformité / Gelijkvormigheids certificaat Declaración de Conformidad/Declaração de Conformidade/Dichiarazione Di Conformita

We:	Bartell Morrison Inc. 170 Traders Blvd. E Mississauga, Ontario, Canada L4Z 1W7 Tel: 647-953-4100 Fax: 647-953-4101	Bartell Morrison (USA) LLC. 200 Commerce Drive, Unit A Freehold, New Jersey, United States of America 07735 Tel: 848-225-8100 Fax: 848-225-8101
-----	---	--

Declare under our sole responsibility that the product to which this declaration relates is in conformity with the following standard(s) or other normative documents.

Déclarons sous notre responsabilité que le produit cette déclaration est conforme aux normes suivantes ou d'autres documents habituels.

Verklaren onder onze verantwoordelijkheid dat het product naar welke de verklaring verwijst conform de volgende standaards of anders gebruikelijke documenten is.

Declaramos bajo nuestra única responsabilidad que el producto en lo que esta declaración concierne, es conforme con la siguiente normativa u otros documentos.

Declara sob sua responsabilidade que o produto a quem esta declaração interessar, está em conformidade com os seguintes documentos legais ou normas directivas.

Dichiariamo sotto la ns. unica responsabilità che il prodotto al quale questa dichiarazione si riferisce, è fabbricato in conformità ai seguenti standard e documenti di normative.

EN 349:1993	Safety of Machinery - Minimum gaps to avoid crushing of parts of the human body.
EN 418:1993	Safety of Machinery - Emergency stop equipment, functional aspects - Principles for design
EN 12100-1:2003	Safety of Machinery - Basic Concepts, general principles for design - Part 1: Basic Terminology, methodology
EN 12100-2:2003	Safety of Machinery - Basic Concepts, general principles for design - Part 2: Technical Principles
EN ISO 4872:1978	Acoustics - Measurement of Airborne noise emitted by construction equipment intended for outdoor use - Method for determining compliance with noise limits.
EN ISO 5349-1:2001	Mechanical vibration. Measurement and evaluation of human exposure to hand-transmitted vibration. General requirements
EN ISO 5349-2:2001	Mechanical vibration. Measurement and assessment of human exposure to hand-transmitted vibration. Practical guidance for measurement at the workplace.

Following the provisions of Directive(s):

Suivant les directive(s) déterminées:

Volgens de vastgestelde richtlijnen:

Siguiendo las directiva(s):

No seguimento das clausulas da Directiva(s):

Seguendo quanto indicato dalla Direttiva(s):

98/37/EC	Machinery Directive
2000/14/EC	Noise Directive
2001/95/EC	General Product Safety Directive
2002/95/EC	Reduction of Hazardous Waste Directive

NORTH AMERICA

CONTEC

BARTELL  GLOBAL



Bartell Morrison Inc.
 170 Traders Blvd E
 Mississauga, Ontario, Canada
 L4Z 1W7
 Tel: 1-647-953-4100
 Fax: 1-647-953-4101



Bartell Morrison (USA) LLC
 200 Commerce Drive, Unit A
 Freehold, New Jersey, USA
 07728
 Tel: 1-848-225-8100
 Fax: 1-848-225-8101



Innovatech
 4701 Allmond Ave
 Louisville, Kentucky, USA
 40209
 Tel: (425) 405-9100
 Fax: (425) 405-9101



SPE International
 Honeyholes Lane
 Dunholme, Lincoln, UK
 LN2 3SU
 Tel: +44 (0)1673 860709
 Fax: +44 (0)1673 861119



**BARTELL
 GLOBAL**

**5 BRANDS - 1 SOURCE FOR
 GREAT EQUIPMENT**

BARTELL morrison   

BARTELLGLOBAL.COM