



**OWNER'S  
MANUAL**

**PARTS  
BOOK**

# WALKBEHIND MATERIAL SPREADER

MS20



Page intentionally left blank.

[www.BartellGlobal.com](http://www.BartellGlobal.com)

**CANADA**

170 Traders Blvd E  
Mississauga, Ontario L4Z 1W7  
TEL (647) 953-4100 FAX (647) 953-4101

**KENTUCKY**

4701 Allmond Ave  
Louisville, Kentucky 40209  
TEL (425) 405-9100 FAX (425) 405-9101

**UK**

Honeyholes Lane  
Dunholme, Lincoln, UK LN2 3SU  
TEL 01673 860709 FAX 01673 861119

**NEW JERSEY**

200 Commerce Drive, Unit A  
Freehold, New Jersey 07728  
TEL (848) 225-8100 FAX (848) 225-8101

**ORIGINAL LANGUAGE OPERATING MANUAL FOR  
BARTELL RIDE-ON TROWELS**

© 2024 Bartell Global Inc.

No part of this work may be reproduced or transmitted in any form or by any means, electronic or mechanical, including photocopying and recording, or by any information storage or retrieval system without the prior written permission of Bartell Morrison Inc. unless such copying is permitted by federal copyright laws.

**ADDRESS INQUIRIES OR REFERENCE PERMISSIONS CARE OF:**

Bartell Global, 170 Traders Blvd E., Mississauga, Ontario, Canada, L4Z 1W7

REV.	DATE	DESCRIPTION	APPROVED BY:
00	03/15	ORIGINAL RELEASE	-
01	07/24	UPDATED FORMAT and LOGOS	AN

## SAFETY PRECAUTIONS



### **WARNING** **ROTATING HAZARD**

Never place hands or feet inside the hopper. Serious injury will result from contact with rotating auger.



### **CAUTION** **MOVING PARTS**

Before starting the machine, ensure that all guards and safety devices are in place and functioning properly.



### **ATTENTION** **READ OWNER'S MANUAL**

Read and understand owner's manual before using this machine. Failure to follow operating instructions could result in serious injury or death.

**TABLE OF CONTENTS**

<b><u>WARRANTY</u></b>	<b><u>5</u></b>
<b><u>SPECIFICATIONS</u></b>	<b><u>5</u></b>
<b><u>QUALITY ASSURANCE/MACHINE BREAK IN</u></b>	<b><u>6</u></b>
<b><u>ROUTINE SERVICE INTERVAL</u></b>	<b><u>8</u></b>
<b><u>OPERATION</u></b>	<b><u>8</u></b>
<b><u>ASSEMBLY INSTRUCTIONS</u></b>	<b><u>9</u></b>
<b><u>ASSEMBLY DRAWING AND PARTS LIST</u></b>	<b><u>13</u></b>

## **WARRANTY**

### **WALK BEHIND MATERIAL SPREADER**

Bartell agrees to furnish without charge, F.O.B. our plant, a replacement for any part or portion thereof, the Material Spreader, to be defective in either material or workmanship within a period of twelve (12) months from date of purchase, provided that notice of such defective part or portion thereof is given to Bartell Morrison Inc. Within the twelve months warranty period. No further or other guarantee or warranty expressed or implied in connection with the sale of the Material Spreader is given and our sole liability consists in replacing defective parts or portions thereof. We shall not be responsible for any special, indirect or consequential damages arising in any manner whatsoever.

This guarantee is for the sole benefit of the original purchaser as end user. Our responsibility under this guarantee ends in the case the original purchaser transfers ownership of the Material Spreader, make any changes.

## **SPECIFICATIONS**

<b>DIMENSIONS</b>	
Length (handle up)	95cm (37.4")
Height (handle up)	93cm (36.6")
Length (handle down)	65cm (25.6")
Height (handle down)	62cm (24.4")
Width	130cm (51.1")
Discharge Width	99cm (39")
Weight	60kg (132.3lbs)

## **QUALITY ASSURANCE/MACHINE BREAK IN**

The Bartell Ride-on Trowel is the product of extensive engineering development designed to give long life and unmatched performance. Once machines are fully assembled, a run-in test is performed to ensure quality standards of the highest level. A series of operational tests are conducted on concrete, incorporating a phase of operations at 1/2 to 3/4 throttle and a final run phase at full throttle for a minimum of 20 minutes.

You can help ensure that your Ride-on will perform at top levels by following a simple routine on first use. Consider that your new Ride-on Trowel is like a new car. Just as you would break in a new car to the road or any new machine to the job, you should start gradually and build up to full use. Learn what your machine can do and how it will respond. Refer to the engine manufacturer's manual for run-in times. Full throttle and control may be used after this time, as allowed by material. This will serve to further break in the machine on your specific application, as well as provide you with additional practice using the machine.

We thank you for the confidence you have placed in us by purchasing a Bartell Ride-on Trowel and wish you many years of satisfied use.





## **ROUTINE SERVICE INTERVAL**

Due to the nature and environment of use, the Material Spreader could be exposed to severe operating conditions. Some general maintenance guidelines will extend the useful life of your machine.

- Regular service will prolong the life of the Material Spreader and prevent expensive repairs.
- Keeping your Material Spreader clean and free from debris is the single most important regular maintenance operation, over and above the checks in the service schedule that can be performed.
- After each use your Material Spreader should be emptied and cleaned to remove any dust and debris from the hopper, gate opening and surrounding components.
- Check the gate control handle for smooth operation.
- Failure to have your Material Spreader regularly serviced and properly maintained in accordance with the manufacturer's instructions will lead to premature failure and void of the warranty.

## **OPERATION**

- Close the gate before adding any material into the hopper.
- Perform testing to determine a proper gate opening and proper working speed in relation to the desired quantity of material to be spread for the number of spreading passes.
- For best performance during spreading, keep the hopper over half full.

## **ASSEMBLY INSTRUCTIONS**

**Step 1:** Take wheels and spreader out of the box.

**Step 2:** The wheel mounting bolts will already be on the hubs for the wheels

**Step 3:** Mount wheels to the mounting plate and secure mounting bolts



**Step 4:** Material Spreader shown with handle in the folded down position.

**Step 5:** Raise handle and align slot with stud.



**Step 6:** Slide slot onto the stud.



**Step 7:** Tighten knob to secure the handle in place.

Page intentionally left blank.

Page intentionally left blank.

**ASSEMBLY DRAWING AND PARTS LIST**

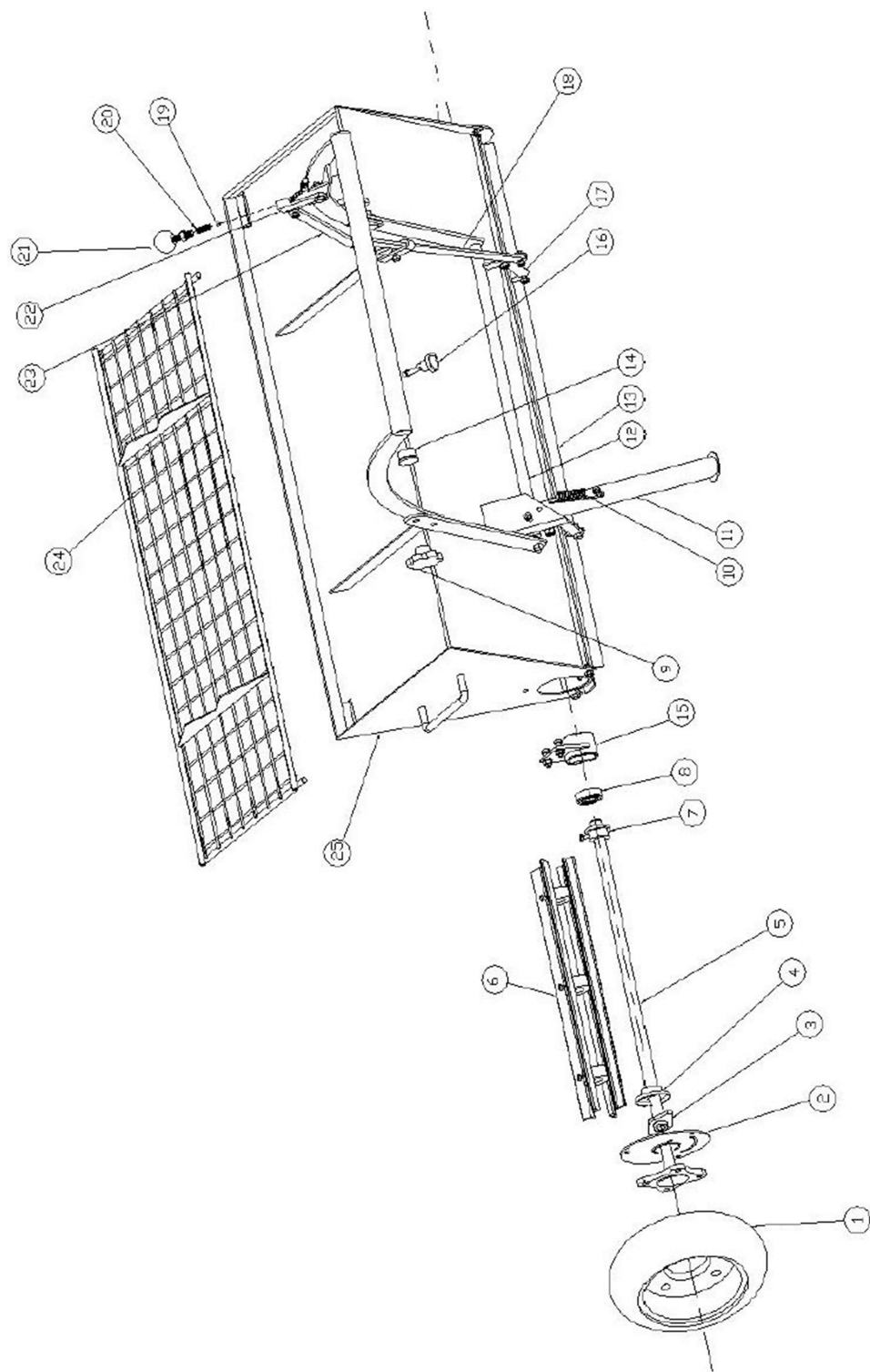

Item #	Part #	Description	QTY	Remarks
1	88001	WHEEL	2	
2	88002	PLATE	2	
3	88003	DIAMOND BEARING	2	
4	88004	BEARING BLOCK	2	
5	88005	WHEEL SHAFT	2	
6	88006	AXLE	2	
7	88007	BEARING BLOCK	2	
8	88008	BEARING	2	
9	88009	KNOB	2	
10	88010	SPRING	1	
11	88011	STAND	1	
12	88012	CONNECTING ROD	1	
13	88013	BAFFLE	1	
14	88014	PLUG	2	
15	88015	BEARING HOUSING	1	
16	88016	LOACK PIN	1	
17	88017	SHORT ROD	2	
18	88018	LONG ROD	1	
19	88019	BALL	1	
20	88020	SPRING	1	
21	88021	CONTROL KNOB	1	
22	88022	ADJUSTER	1	
23	88023	ROD	1	
24	88024	NET	1	
25	88025	HOPPER	1	



CONTRACTOR PROVEN EQUIPMENT SINCE 1946



170 Traders Blvd E  
Mississauga, ON L4Z 1W7  
Canada

4701 Allmond Avenue  
Louisville, KY 40209  
United States

200 Commerce Drive  
Freehold, NJ 07728  
United States

Honeyholes Lane  
Dunholme, Lincoln LN2 3SU  
United Kingdom

